

# STARTER SPECIFICATION DATA SHEET

## New & Retrofit

GALI 1/1

• Customer

• Project

### A) ENGINE DATA

#### 1. General data

Maker  
 Model  
 Bore (mm)  
 Stroke (mm)  
 Number of cylinders  
 Number of ring gear teeth  
 Sense of rotation (CW/CCW)  
 (engine - viewed from flywheel end)  
 Sense of rotation (CW/CCW)  
 (starter - viewed from pinion end)  
 Firing speed (rpm)  
 Breakaway torque (N·m)  
 Fuel system (diesel, NG, DF)

#### 2. Starter installation method

COUPLING FLANGE SAE J542 <sup>(1)</sup>

Specify type (1, 2, 3, 4 or 5):

1. If there is any coupling dimension not according to SAE J542, specify below or provide drawing:

- diameter 'A' ..... mm
- diameter 'B' ..... mm
- diameter 'C' ..... mm
- angle '1' ..... °
- angle '2' ..... °
- angle '3' ..... °
- front distance 'D' ..... mm
- max. nose dim. 'E' ..... mm

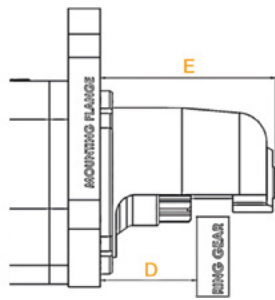
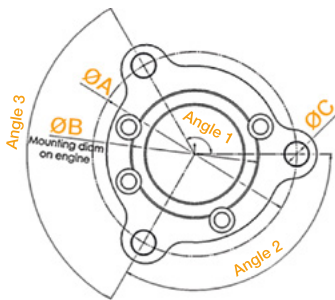

BRACKET <sup>(2)</sup>

CRADLE <sup>(2)</sup>

2. If the installation method is not according to SAE J542, please provide bracket or cradle drawing

#### 3. Existing starter data

Brand and model  
 Complete reference N°  
 (see nameplate)  
 Type (pneumatic/electric/hydraulic)

#### 4. Existing pinion data

Number of teeth  
 Normal modul or DP  
 Tip diameter (ØF) (mm)  
 Inner diameter (ØG) (mm)  
 Base tangent length 2 teeth (H) (mm)

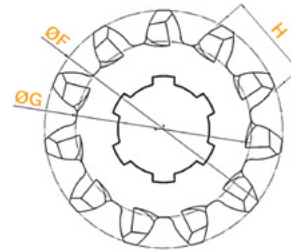

### B) APPLICATION DATA

#### 1. Type of starter

PNEUMATIC <sup>(1)</sup>

HYDRAULIC <sup>(2)</sup>

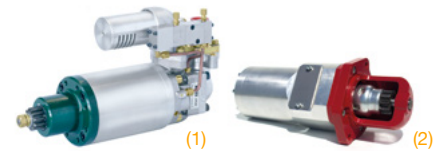

#### 2. Intended application

- |                                             |                                           |
|---------------------------------------------|-------------------------------------------|
| <input type="checkbox"/> MARINE             | <input type="checkbox"/> OFF-SHORE        |
| <input type="checkbox"/> PROPULSION         | <input type="checkbox"/> MINING           |
| <input type="checkbox"/> GENSET             | <input type="checkbox"/> FIRE PUMP        |
| <input type="checkbox"/> POWER PLANT GENSET | <input type="checkbox"/> OTHERS (specify) |

#### 3. Starting requirements

MINIMUM STARTING ATTEMPTS  
 AVAILABLE TANK CAPACITY (m³)  
 AVAILABLE MAX. TANK PRESSURE (MPa)

#### 4. Special starting requirements

- SLOW TURN OR CRANKING PERIODE  
 Number of engine turns  
 Duration (sec)
- NFPA 20 SECTION 11.2.5 (FIRE PUMPS)
- OTHERS (specify)

#### 5. Certification requirements

Please specify

### C) OTHER REQUIREMENTS

- ENGINE 3D MODEL (starter side surrounding + ring gear)  
 ENGINE SPECIFICATION SHEET  
 RING GEAR DRAWING (with teeth data and tooth chamfer details)  
 PHOTO OF EXISTING STARTER AND PINION